

Plastic Pipes & Fittings Factory  
Yousif Khalid Al-Adasani Ent.

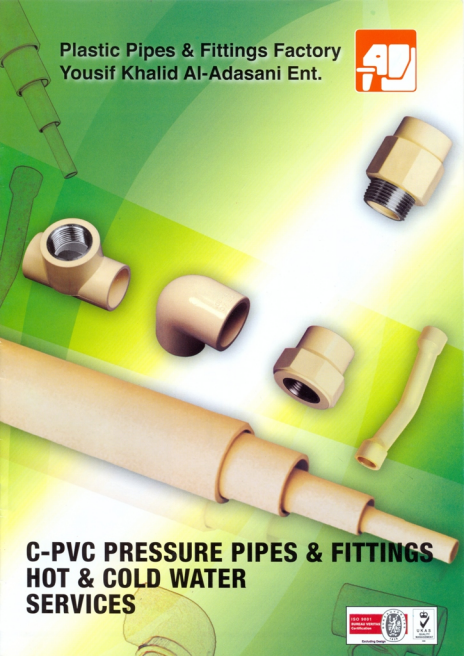

**C-PVC PRESSURE PIPES & FITTINGS**  
**HOT & COLD WATER**  
**SERVICES**



## C-PVC Pressure Pipes

DIN 8079 / 8080, DIN / BS EN ISO 15877 and Kuwaiti Standard 881

| d<br>(outside<br>diameter in mm) | Pipe Series                                  |                |                                |                |
|----------------------------------|----------------------------------------------|----------------|--------------------------------|----------------|
|                                  | 6.3                                          |                | 4                              |                |
|                                  | Diameter - Wall thickness relationship (SDR) |                |                                |                |
|                                  | 13.6                                         |                | 9                              |                |
|                                  | Nominal Pressure, PN                         |                |                                |                |
|                                  | PN 16                                        |                | PN 25                          |                |
|                                  | s<br>(wall thickness<br>in mm)               | Weight<br>Kg/m | s<br>(wall thickness<br>in mm) | Weight<br>Kg/m |
| 20                               | 1.5                                          | 0.151          | 2.3                            | 0.217          |
| 25                               | 1.9                                          | 0.234          | 2.8                            | 0.326          |
| 32                               | 2.4                                          | 0.379          | 3.6                            | 0.533          |
| 40                               | 3.0                                          | 0.589          | 4.5                            | 0.830          |
| 50                               | 3.7                                          | 0.896          | 5.6                            | 1.280          |
| 63                               | 4.7                                          | 1.420          | 7.1                            | 2.050          |
| 75                               | 5.6                                          | 2.010          | 8.4                            | 2.88           |
| 90                               | 6.7                                          | 2.880          | 10.1                           | 4.15           |
| 110                              | 8.1                                          | 4.270          | 12.3                           | 6.16           |
| 160                              | 11.8                                         | 8.970          | 17.9                           | 13.0           |

PN = Nominal Pressure in bar



d : outside diameter  
s : wall thickness  
measurements in mm

## C-PVC Pressure Pipe Fittings

DIN / BS EN ISO 15877

### Elbow 90° (GIC)

| d <sub>1</sub> | d <sub>2</sub> | t    | z    |
|----------------|----------------|------|------|
| 20             | 27.5           | 16.5 | 12.0 |
| 25             | 33.3           | 19.5 | 14.2 |
| 32             | 41.0           | 22.5 | 19.3 |
| 40             | 49.7           | 26.0 | 22.3 |
| 50             | 61.0           | 31.0 | 27.5 |
| 63             | 75.0           | 38.0 | 34.4 |
| 75             | 91.0           | 45.0 | 38.5 |
| 90             | 107.5          | 51.5 | 47.5 |
| 110            | 130.5          | 61.5 | 60.2 |

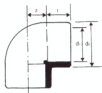

### Elbow 45° (HIC)

| d <sub>1</sub> | d <sub>2</sub> | t    | z    |
|----------------|----------------|------|------|
| 20             | 27.5           | 16.5 | 12.0 |
| 25             | 33.3           | 19.5 | 14.2 |
| 32             | 41.0           | 22.5 | 19.3 |
| 40             | 49.7           | 26.0 | 22.3 |
| 50             | 61.0           | 31.0 | 27.5 |
| 63             | 75.0           | 38.0 | 34.4 |
| 75             | 91.0           | 45.0 | 38.5 |
| 110            | 131            | 61.5 | 48   |



### Tee 90° (TIC)

| $d_1$ | $d_2$ | $t$  | $z$  |
|-------|-------|------|------|
| 20    | 27.5  | 16.5 | 2.0  |
| 25    | 33.3  | 19.5 | 14.2 |
| 32    | 41.0  | 22.5 | 19.3 |
| 40    | 49.7  | 26.0 | 22.3 |
| 50    | 61.0  | 31.0 | 27.5 |
| 63    | 75.0  | 38.0 | 34.4 |
| 75    | 91.0  | 45.0 | 38.5 |
| 90    | 107.5 | 51.5 | 47.5 |
| 110   | 130.5 | 61.5 | 60.2 |



### Double Socket (MIC)

| $d_1$ | $d_2$ | $t$  | $z$  |
|-------|-------|------|------|
| 20    | 27.5  | 16.5 | 2.0  |
| 25    | 33.3  | 19.5 | 14.2 |
| 32    | 41.0  | 22.5 | 19.3 |
| 40    | 49.7  | 26.0 | 22.3 |
| 50    | 61.0  | 31.0 | 27.5 |
| 63    | 75.0  | 38.0 | 34.4 |
| 75    | 91.0  | 45.0 | 38.5 |
| 90    | 107.5 | 51.5 | 47.5 |
| 110   | 130.5 | 61.5 | 60.2 |

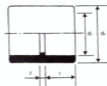

### Short Reducing Bushes (DIC)

| $d_1 \times d_2$ | $t_1$ | $t_2$ | $z$  |
|------------------|-------|-------|------|
| 25/20            | 19.5  | 16.5  | 3.0  |
| 32/20            | 22.5  | 16.5  | 6.0  |
| 32/25            | 22.5  | 19.5  | 3.0  |
| 40/20            | 26.0  | 16.5  | 9.5  |
| 40/25            | 26.5  | 19.5  | 7.0  |
| 40/32            | 26.5  | 22.5  | 4.0  |
| 50/20            | 31.0  | 16.0  | 15.0 |
| 50/25            | 31.0  | 19.0  | 12.0 |
| 50/32            | 31.0  | 22.5  | 8.5  |
| 50/40            | 31.0  | 26.0  | 5.0  |
| 63/32            | 38.0  | 22.5  | 16.5 |
| 63/40            | 38.0  | 26.0  | 12.0 |
| 63/50            | 38.0  | 31.0  | 7.0  |
| 75/32            | 45.0  | 23.0  | 22.0 |
| 75/40            | 45.0  | 26.5  | 18.5 |
| 75/50            | 45.0  | 32.2  | 12.7 |
| 75/63            | 45.0  | 38.5  | 6.5  |
| 90/40            | 61.2  | 26.5  | 34.7 |
| 90/50            | 61.2  | 32.1  | 29.1 |
| 90/63            | 61.2  | 38.5  | 22.7 |
| 90/75            | 61.2  | 44.0  | 17.2 |
| 110/63           | 61.7  | 39.2  | 22.0 |
| 110/75           | 61.7  | 44.8  | 16.9 |
| 110/90           | 61.7  | 39.2  | 22.0 |

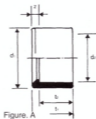

Figure. A

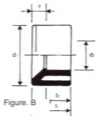

Figure. B



| $d_1$ | $d_2$ | $t$  | H     |
|-------|-------|------|-------|
| 20    | 27.6  | 16.5 | 23.2  |
| 25    | 33.2  | 19.5 | 26.3  |
| 32    | 41.1  | 22.5 | 30.85 |
| 40    | 51    | 26   | 36    |
| 50    | 62    | 31   | 43    |
| 63    | 77    | 38   | 51    |
| 90    | 110.0 | 51.5 | 68.0  |
| 110   | 133.5 | 61.5 | 82.0  |



### Elbow 90° Female Threaded (GIMC)

with one socket for solvent welding and one threaded + reinforcing metal ring

| $d \times d'$ | $d_2$ | $d_1'$ | $z$  | $t$  |
|---------------|-------|--------|------|------|
| 40 x 1 1/4"   | 50.0  | 52.0   | 22.3 | 26.0 |
| 50 x 1 1/2"   | 61.0  | 64.5   | 27.5 | 31.0 |
| 63 x 2"       | 75.0  | 77.6   | 34.4 | 38.0 |

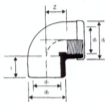

### Tee 90° Equal Female Threaded (TIMC)

with two sockets for solvent welding and threaded branch + reinforcing metal ring

| $d_1 \times d_1'$ | $d_2$ | $d_2'$ | $z$  | $t$  |
|-------------------|-------|--------|------|------|
| 40 x 1 1/4"       | 50.0  | 53.0   | 23.0 | 26.0 |
| 50 x 1 1/2"       | 62.0  | 64.5   | 28.0 | 31.0 |
| 63 x 2"           | 77.0  | 79.8   | 36.0 | 38.0 |

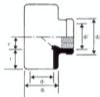

### Elbow 90° Reduced Female Threaded (GRFC)

with one socket for solvent welding and one reduced threads

| $d \times d'$ | $d_2$ | $d_1'$ | $z$  | $t$  |
|---------------|-------|--------|------|------|
| 25 x 1/2"     | 33.0  | 33.0   | 13.2 | 19.5 |

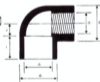

### Tee 90° Reduced Female Threaded (TRFC)

with two sockets for solvent welding and reduced threaded branch

| $d_1 \times d_1'$ | $d_2$ | $d_2'$ | $L_2$ | $z$  | $t$  |
|-------------------|-------|--------|-------|------|------|
| 25 x 1/2"         | 33.0  | 33.0   | 33.0  | 13.2 | 19.5 |

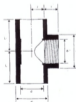

### Socket union (BIC)

Sockets for solvent welding

| d  | H  | L  | Z  | E    |
|----|----|----|----|------|
| 20 | 45 | 16 | 13 | 41.0 |
| 25 | 51 | 19 | 13 | 50.0 |
| 32 | 57 | 22 | 13 | 58.0 |
| 40 | 67 | 26 | 15 | 72.0 |
| 50 | 79 | 31 | 17 | 79.0 |
| 63 | 98 | 38 | 22 | 96.0 |

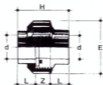

### Threaded Short Reducer (DIFC)

| d, x d'   | d' | t  |
|-----------|----|----|
| 25 x 1/2" | 33 | 21 |

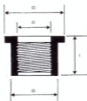

### Tee 90° Equal TIFC

with two sockets for solvent welding and threaded branch

| d, x d'   | d <sub>s</sub> | d'   | L <sub>s</sub> | z    | t    |
|-----------|----------------|------|----------------|------|------|
| 25 x 1/2" | 33.0           | 41.0 | 33.0           | 13.0 | 19.5 |

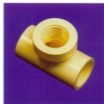

### Elbow 90° Female Threaded (GIFC)

with one socket for solvent welding and one threads

| d, x d'   | d <sub>s</sub> | d'   | z    | t    |
|-----------|----------------|------|------|------|
| 25 x 1/2" | 33.0           | 41.0 | 13.5 | 19.5 |

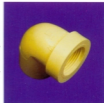

### Female Adapter (MIMC)

with one socket for solvent welding, female end threaded + reinforced metal ring

| d <sub>1</sub> x d <sub>1</sub> ' | d <sub>2</sub> | d <sub>2</sub> ' | t <sub>1</sub> | t <sub>1</sub> ' | z   |
|-----------------------------------|----------------|------------------|----------------|------------------|-----|
| 20 x 1/2"                         | 28.0           | 30.0             | 16.5           | 16               | 3.0 |
| 25 x 3/4"                         | 34.0           | 35.0             | 19.5           | 18               | 3.0 |
| 32 x 1"                           | 42.0           | 45.0             | 22.5           | 20               | 2.5 |
| 40 x 1 1/4"                       | 51.0           | 55.0             | 26.0           | 22               | 2.5 |
| 50 x 1 1/2"                       | 61.0           | 62.0             | 31.0           | 25               | 3.0 |
| 63 x 2"                           | 75.5           | 75.0             | 38.0           | 27               | 3.5 |

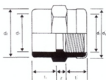

### Male Adapter (KIFC)

with one socket for solvent welding, male end threaded

| d <sub>1</sub> | d <sub>1</sub> ' | d <sub>2</sub> | d <sub>2</sub> ' | t <sub>1</sub> | t <sub>1</sub> ' | t <sub>2</sub> | H     |
|----------------|------------------|----------------|------------------|----------------|------------------|----------------|-------|
| 20             | 1/2"             | 27.5           | 32.0             | 16.50          | 14.00            | 16.6           | 40    |
| 25             | 3/4"             | 33.0           | 36.0             | 19.50          | 16.00            | 19.0           | 44    |
| 32             | 1"               | 41.0           | 46.0             | 22.50          | 18.00            | 21.8           | 50    |
| 40             | 1 1/4"           | 49.5           | 54.5             | 26.00          | 23.00            | 24.0           | 56.5  |
| 50             | 1 1/2"           | 60.8           | 64.5             | 31.00          | 28.00            | 24.0           | 62.0  |
| 63             | 2"               | 75.0           | 79.4             | 38.00          | 36.00            | 28.0           | 75.5  |
| 75             | 2 1/2"           | 75.0           | 79.4             | 38.00          | 36.00            | 28.0           | 75.5  |
| 90             | 3"               | 109.3          | 110              | 51.1           | 61.5             | 34             | 111.8 |
| 110            | 4"               | 129            | 129.0            | 61.5           | 70.0             | 39.5           | 34    |



### Double Threaded Connector (NMC)

| d <sub>1</sub> | d <sub>2</sub> | t <sub>1</sub> | t <sub>2</sub> | H  |
|----------------|----------------|----------------|----------------|----|
| 1/2"           | 21.5           | 15.0           | 15.0           | 38 |
| 3/4"           | 29.5           | 17.0           | 17.0           | 44 |



### Mono D'Clips (MDC)

| 2R | A   | B    | R    |
|----|-----|------|------|
| 20 | 6   | 18.5 | 10   |
| 25 | 8   | 23.5 | 12.5 |
| 32 | 8.5 | 28.0 | 16.0 |



### Female Adaptor with Nickle Plated Insert

with one socket for solvent welding, and  
one female end with metal threads

| Code | $d_1 \times d_1'$ | $d_2$ | $d_2'$ |
|------|-------------------|-------|--------|
| MINC | 20 x 1/8"         | 27.6  | 10.3   |
| MRNC | 25 x 1/8"         | 33.3  | 46.0   |
| MINC | 25 x 3/4"         | 33.2  | 46.0   |
| MRNC | 32 x 3/4"         | 40.8  | 51.0   |
| MINC | 32 x 1"           | 40.8  | 51.0   |
| MRNC | 40 x 1"           | 50.0  | 60.7   |
| MINC | 40 x 1 1/4"       | 50.0  | 60.7   |
| MRNC | 50 x 1 1/4"       | 63.0  | 70.3   |
| MINC | 50 x 1 1/2"       | 63.0  | 70.3   |
| MRNC | 63 x 1 1/2"       | 75.0  | 81.5   |
| MINC | 63 x 2"           | 75.0  | 81.5   |

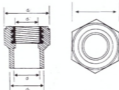

### Male Adaptor with Nickle Plated Insert

with one socket for solvent welding, and  
one male end with metal threads

| Code | $d_1 \times d_1'$ | $d_2$ | $d_2'$ |
|------|-------------------|-------|--------|
| KINC | 20 x 1/8"         | 27.3  | 10.3   |
| KINC | 25 x 1/8"         | 32.2  | 15.5   |
| KINC | 32 x 1"           | 40.3  | 21.0   |
| KRNC | 40 x 1"           | 50.0  | 20.5   |
| KINC | 40 x 1 1/4"       | 50.0  | 28.0   |
| KRNC | 50 x 1 1/4"       | 62.9  | 28.0   |
| KINC | 50 x 1 1/2"       | 62.9  | 33.5   |
| KRNC | 63 x 1 1/2"       | 74.9  | 33.5   |
| KINC | 63 x 2"           | 74.9  | 42.0   |

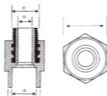

### Elbow 90° Adaptor with Nickle Plated Insert

with one socket for solvent welding  
and one with metal threads

| Code | $d_1 \times d_2'$ | $d_2$ | t    | z    |
|------|-------------------|-------|------|------|
| GINC | 20 x 1/8"         | 37.0  | 16.5 | 12.5 |
| GRNC | 25 x 1/2"         | 43.0  | 19.5 | 15.5 |
| GINC | 25 x 3/4"         | 43.0  | 19.5 | 15.5 |
| GRNC | 32 x 3/4"         | 49.0  | 22.5 | 17.0 |
| GINC | 32 x 1"           | 49.0  | 22.5 | 17.0 |
| GINC | 40 x 1 1/4"       | 59    | 26   | 22   |
| GINC | 50 x 1 1/2"       | 70    | 31   | 27   |
| GINC | 63 x 2"           | 85    | 38   | 33   |

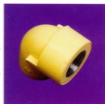

### Tee 90° Adaptor with Nickle Plated Insert

with two sockets for solvent welding  
and one with metal threaded branch

| Code | $d_1 \times d_2'$ | $d_2$ | $d_2'$ | t    | z     |
|------|-------------------|-------|--------|------|-------|
| TINC | 20 x 1/2"         | 27.5  | 37.0   | 16.5 | 12.25 |
| TRNC | 25 x 1/2"         | 34.2  | 43.0   | 19.5 | 15.0  |
| TINC | 25 x 3/4"         | 34.2  | 43.0   | 19.5 | 15.0  |
| TRNC | 32 x 3/4"         | 40.5  | 49.0   | 22.5 | 17.5  |
| TINC | 32 x 1"           | 40.5  | 49.0   | 22.5 | 17.5  |
| TINC | 40 x 1 1/4"       | 50    | 59     | 26   | 21.5  |
| TINC | 50 x 1 1/2"       | 61    | 68     | 31   | 27.0  |
| TINC | 63 x 2"           | 75    | 85     | 38   | 33.5  |



### Step-over bend (SOBC)

| D  | H    | $h_1$ | $h_2$ | L <sub>1</sub> | L <sub>2</sub> |
|----|------|-------|-------|----------------|----------------|
| 25 | 58.0 | 35    | 32    | 22             | 201            |
| 32 | 66   | 43    | 34.5  | 22.5           | 172            |



### Slanted seat valve (GVC)

| D  | t  | Z  | L   |
|----|----|----|-----|
| 25 | 16 | 86 | 118 |
| 32 | 18 | 82 | 118 |



### Concealed / shut off valve (CVC)

| D  | R    | t  | Z  | L   |
|----|------|----|----|-----|
| 20 | 3/4" | 15 | 66 | 96  |
| 25 | 3/4" | 16 | 64 | 96  |
| 32 | 1"   | 18 | 80 | 116 |

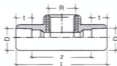

Note:

For other sizes of fittings not listed in this catalogue or other types of pipe accessories please contact our sales department.

All sizes in mm otherwise mentioned.



**Plastic Pipes & Fittings Factory**  
**Yousif Khalid Al-Adasani Ent.**

P.O. box 1653 SAFAT 13017 SAFAT, KUWAIT / Sabhan Industrial Area Cable: YOUKADSAN  
Tel.: 2474 3800 - 2474 3801 - 2473 0225 - 2473 0226 - 2471 4870 - Fax No.: 2471 8258 - 2476 4115  
Website: [www.aladasani.com](http://www.aladasani.com) - Email: [yadasani@aladasani.com](mailto:yadasani@aladasani.com) - [info@aladasani.com](mailto:info@aladasani.com)